



STEPHENSON BROWNE

Goss Place, Alsager

ST7 2LR



£600,000

DESCRIPTION

A FIVE-BEDROOM executive detached family home with a LARGER-THAN-AVERAGE CORNER PLOT AND REAR GARDEN, offering well-proportioned accommodation throughout!

A fantastic opportunity to purchase a spacious family home which benefits from a sizeable rear garden which is much larger than you may expect, and has been landscaped to include a seating area and an office/summerhouse!

The property boasts a brilliant layout consisting of a spacious hallway with under stairs storage and fantastic lounge with French doors opening onto the vast rear garden. The property also enjoys an open plan aspect with it's stunning kitchen diner comprising of high gloss contemporary units, as well as many integrated appliances, such as: dishwasher, fridge freezer, four-point induction hob, eye-level double oven and like the lounge, the area benefits from French doors to the rear garden, giving you a great space for entertaining.

Continuing downstairs, you will find a separate utility area with space and plumbing for a washing machine, downstairs WC and another reception room with the converted double garage, ideal for a gym or office!



Upstairs comprises of five excellently proportioned bedrooms, with the incredible master possessing it's own dressing room, fit with modern mirrored inbuilt wardrobes and it's own en-suite, complete with bath and separate walk in shower! With two more bedrooms having inbuilt fitted wardrobes, and the guest bedroom it's own en-suite, Goss Place really is in a league of it's own. It's also impossible not to mention the generous balcony style landing and stylish family bathroom.

Goss Place is a popular location within Alsager and offers excellent access to commuting routes such as the M6 (Junction 16), the A500 and A34, with Alsager train station only a short distance away. Schools such as Cranberry Academy and Alsager School are only a short distance away, with leisure facilities including Alsager Sports Hub and Alsager Leisure Centre also within easy reach.



ROOM DESCRIPTIONS

Entrance Hall

UPVc panelled entrance door having double glazed frosted insets. Single panel radiator. Understairs storage cupboard.

Lounge

24'3" into bay x 11'1"
Double glazed bay window to the front elevation. Double glazed French doors opening to the rear garden. Single and double panel radiators.

Dining Room

14'11" x 8'9"
Single panel radiator. Double glazed French doors opening to the rear garden. Opening into:-

Kitchen

11'9" x 11'11"
Range of wall, base and drawer units with work surfaces over incorporating a stainless steel 1.5 bowl sink unit with drainer and mixer tap. Integrated double oven with ceramic hob and extractor canopy over. Integrated dishwasher. Double panel radiator. Double glazed window to the rear elevation. Door into:-

Utility Room

5'2" x 6'7"
UPVc panelled door having double glazed frosted insets opening to the rear garden. Range of wall and base units with work surfaces over incorporating a stainless steel sink unit with mixer tap. Space for a washing machine and tumble dryer.

Downstairs WC

5'11" x 3'2"
Two piece suite comprising a low level WC with push button flush and a pedestal wash hand basin with mixer tap. Single panel radiator. Double glazed frosted window to the rear elevation.

Former Double Garage & Study

15'2" x 24'8"
Two double panel radiators. Double glazed window to the front elevation. UPVc panelled door having double glazed frosted insets opening to the rear garden.



First Floor Landing

Doors to all rooms. Loft access point. Storage cupboard housing the hot water cylinder. Double glazed window to the side elevation.

Principal Bedroom

15'11" x 11'1"

Two double glazed windows to the front elevation. Single panel radiator. Door into:-

Dressing Room

6'5" x 6'0" to robes

Single panel radiator. Double glazed window to the front elevation. Fitted wardrobe with hanging rail and shelving. Door into:-

En-Suite

7'11" x 9'1"

Four piece suite comprising a low level WC with push button flush, pedestal wash hand basin with mixer tap, panelled bath with mixer tap and a double shower cubicle with shower over. Partially tiled walls. Double glazed frosted window to the rear elevation. Single panel radiator. Shaver point. Inset spotlighting.

Bedroom Two

12'2" x 9'6"

Double glazed window to the side elevation. Single panel radiator. Fitted wardrobes with hanging rail and shelving.

Bedroom Three

10'4" x 11'1"

Single panel radiator. Double glazed window to the front elevation.

Bedroom Four

11'1" x 10'6"

Single panel radiator. Double glazed window to the side elevation.

Bedroom Five

8'10" x 11'4"

Double glazed window to the rear elevation. Single panel radiator.

Family Bathroom

7'6" x 6'2"

Three piece suite comprising a low level WC with push button flush, pedestal wash hand basin with mixer tap and a panelled bath with mixer tap. Partially tiled walls. Double glazed frosted window to the rear elevation. Heated towel rail. Inset spotlighting.



Externally

To the front of the property is a brick-paved driveway providing ample off-road parking for multiple vehicles, whilst the larger-than-average rear garden includes lawned, patio, artificial lawn and decked areas with a seating terrace, as well as a useful office/summerhouse.

Alsager AML Disclosure

Agents are required by law to conduct Anti-Money Laundering checks on all those buying a property. Stephenson Browne charge £49.99 plus VAT for an AML check per purchase transaction. This is a non-refundable fee. The charges cover the cost of obtaining relevant data, any manual checks that are required, and ongoing monitoring. This fee is payable in advance prior to the issuing of a memorandum of sale on the property you are seeking to buy.

Council Tax Band

The council tax band for this property is

Freehold Tenure & Charges

Whilst we have been advised by our sellers that the property is freehold and an estate charge is payable to cover maintenance for the development of £___ per annum. This is normal for properties of this age. We would advise confirming with your conveyancer the charges prior to exchange of contracts.

NB: Copyright

The copyright of all details, photographs and floorplans remain the possession of Stephenson Browne.

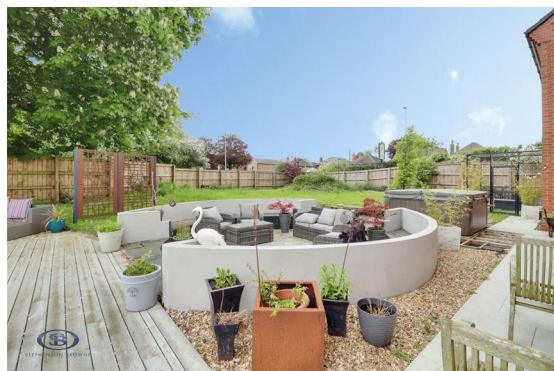





STEPHENSON BROWNE

Viewing

Please contact our office using the details provided below if you are interested in booking a viewing or require further information.

Floorplans

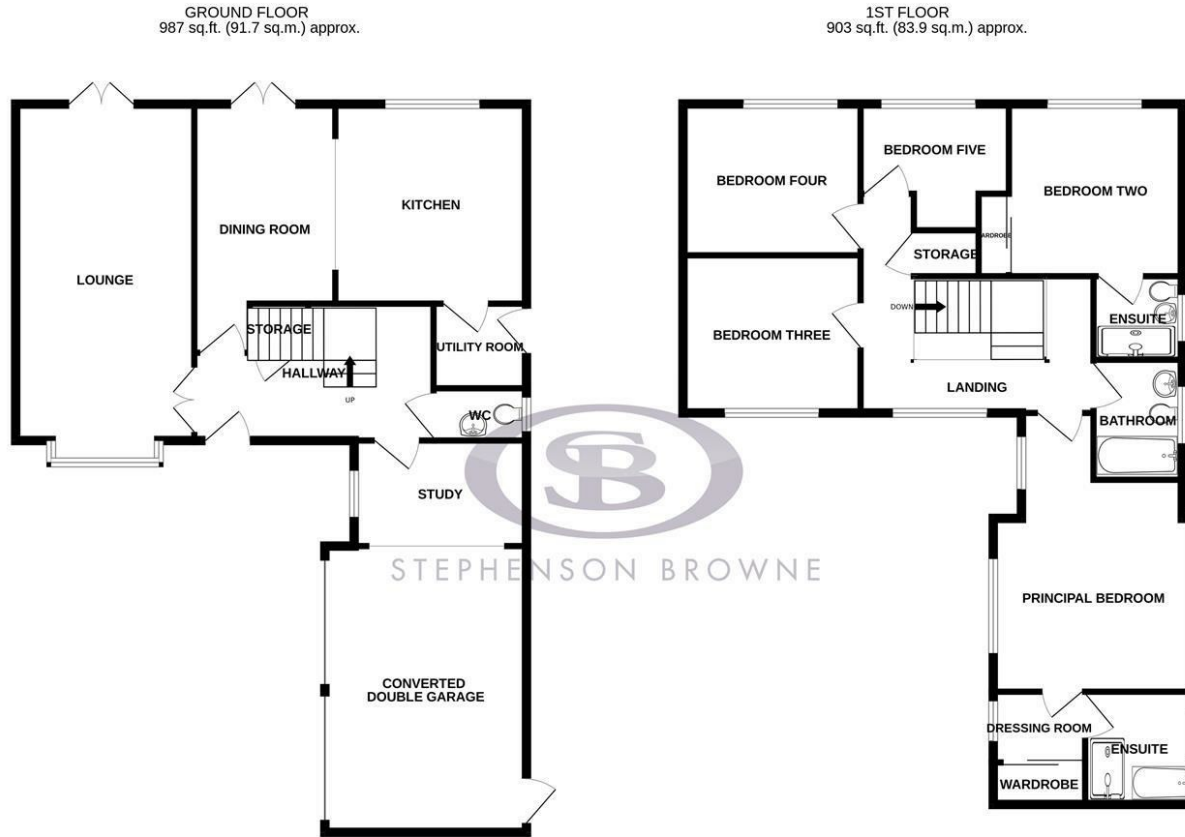

TOTAL FLOOR AREA : 1889 sq.ft. (175.5 sq.m.) approx.
 Whilst every attempt has been made to ensure the accuracy of the floorplan contained here, measurements of doors, windows, rooms and any other items are approximate and no responsibility is taken for any error, omission or mis-statement. This plan is for illustrative purposes only and should be used as such by any prospective purchaser. The services, systems and appliances shown have not been tested and no guarantee as to their operability or efficiency can be given.
 Made with Metropix ©2026

Area Map



EPC Rating

Energy Efficiency Rating		Environmental Impact (CO ₂) Rating	
	Current	Potential	
Very energy efficient - lower running costs			Very environmentally friendly - lower CO ₂ emissions
(92 plus) A			(92 plus) A
(81-91) B			(81-91) B
(69-80) C			(69-80) C
(55-68) D			(55-68) D
(39-54) E			(39-54) E
(21-38) F			(21-38) F
(1-20) G			(1-20) G
Not energy efficient - higher running costs			Not environmentally friendly - higher CO ₂ emissions
England & Wales	EU Directive 2002/91/EC		England & Wales
			EU Directive 2002/91/EC

NOTICE: Stephenson Browne for themselves and for the vendors or lessors of this property whose agents they are give notice that: (1) the particulars are set out as a general guideline only for the guidance of intending purchasers or lessees, and do not constitute, nor constitute part of, an offer or contract; (2) all descriptions, dimensions, references to condition and necessary permissions for use and occupation, and other details are given in good faith and are believed to be correct but any intending purchasers or tenants should not rely on them as statements or representations of fact but must satisfy themselves by inspection or otherwise as to the correctness of each theme; (3) no person in the employment of Stephenson Browne has any authority to make representation or warranty whatever in relation to this property. (4) fixtures & fittings are subject to a formal list supplied by the vendors solicitors. **Referring to: Move with Us Ltd Average Fee: £123.64**

13 Crewe Road, Alsager, Stoke On Trent, ST7 2EW

01270 883130

alsager@stephensonbrowne.co.uk

www.stephensonbrowne.co.uk



STEPHENSON BROWNE